

Lamp Type: GPH357T5LCA/4C

Spec Number:

2536

Engineering Specification Sheet

### Lamp Diagram:

Four Pin Lamp

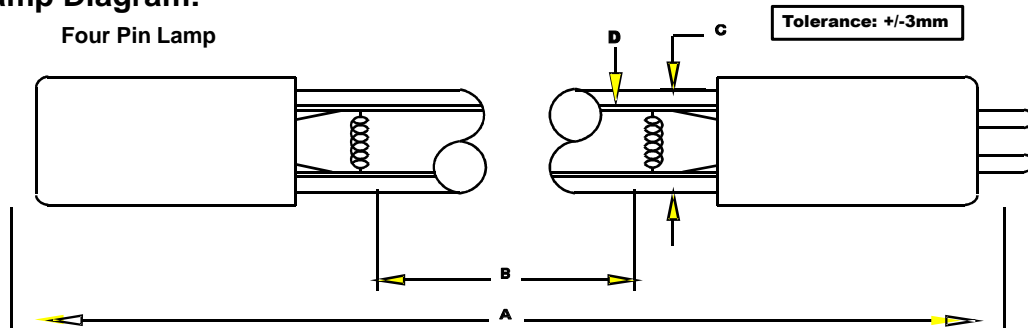

### Lamp Characteristics

(A) Base Face:	357	mm	+/- 3		
(B) ARC:	281	mm		Operating Current	320mA
(C) Bulb Diameter	15	mm		Lamp Voltage:	56v
(X)				Lamp Wattage:	16w
Glass Type:	L (Non-Ozone)	Coating:	A11-QC-001		
If Spliced:	L	mm	VH	mm	
	(Y)				
	(Y1)				

A08-62-C00 HD No Hole Base

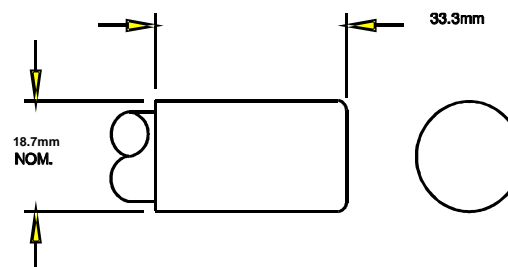

Left Base Diagram:

A08-61-CP0 HD Four-Pin Base

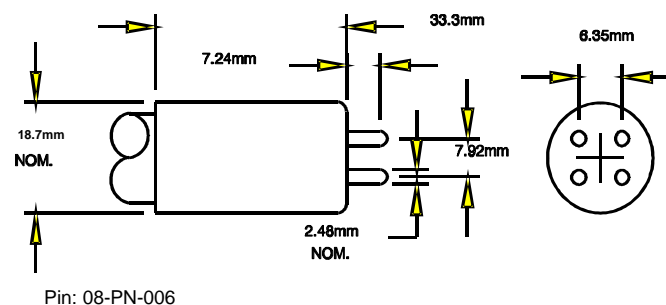

Right Base Diagram:

### UV Output - Certified to be true. First Light Technologies, Inc.

Output UVC Watts	micro/watt	/cm^2 @ 1 Meter	Rated Life (hrs)	% Output @EOL	Output Notes Field	Ballast Used for Measurements
6.6		66	12000	80.00%		TB-002



212 Ideal Way  
Poultney, VT 05764 USA  
Phone-(802) 287-4195 Fax-(802) 287-4489  
www.firstlightusa.com  
email: sales@firstlightusa.com

\*UV Output is based on lamps measured after 100 hours of operation under lab conditions.

These values are subject to wide variations under application/field conditions.

\*\*\*UV Output is measured at 254 nm\*\*\*

\*\*Rated Life is for reference purposes only and is based on a group of lamps operating under lab conditions. Actual life depends on the operating conditions of the lamp.

6/15/2022

12:31:29 PM

This data includes matters which are trade secrets of First Light Technologies, Inc., or Proprietary or Confidential to First Light Technologies, Inc. and shall not be reproduced or disclosed in whole or part, or used in any manner except in connection with First Light Technologies, Inc. business, without the written permission of First Light Technologies, Inc.